

2466

ORDINANCE NO. _____

AN ORDINANCE amending King County Zoning Resolution No. 25789, as amended, by amending the Zoning Map thereof reclassifying certain property thereon at the request of John F. Farman, Division of Land Use Management File No. 213-75-R.

BE IT ORDAINED BY THE COUNCIL OF KING COUNTY:

SECTION 1. John F. Farman petitioned on January 8, 1975, that the property described in Section 3 below be reclassified from RM-900 to G and this application was assigned Division of Land Use Management File No. 213-75-R.

SECTION 2. The report and recommendation of the Division of Land Use Management was transmitted to the Zoning and Subdivision Examiner on March 25, 1975, and hearing was held by the Examiner on the matter April 1, 1975. The report of the Examiner was filed with the Clerk of the King County Council on April 16, 1975, and the Council approved the reclassification by Motion No. 1953 on April 28, 1975.

SECTION 3. The legal description of the property to be reclassified is attached as Appendix A and is hereby made a part of this ordinance. The above described property is shown on the attached map which is designated Appendix B and is hereby made a part of this ordinance.

SECTION 4. The King County Council does hereby amend King County Zoning Code, Resolution No. 25789, as amended, by reclassifying that property described and shown in Section 3, Appendices A and B above, to G and

1
2
3
4
5
6
7
8
9
10
11
12
13
14
15
16
17
18
19
20
21
22
23
24
25
26
27
28
29
30
31

directs that Area Map W 23-20-6 be modified to so designate.

INTRODUCED AND READ for the first time this 3rd day

of March, 1975.

PASSED at a regular meeting of the King County Council

this 11th day of August, 1975.

KING COUNTY COUNCIL
KING COUNTY, WASHINGTON

Bill Reams

Chairman

ATTEST:

Jessie M. Owens
Clerk of the Council

DEEMED ENACTED WITHOUT
COUNTY EXECUTIVE'S SIGNATURE. 5
DATED: August 21, 1975.

APPROVED this _____ day of _____

KING COUNTY EXECUTIVE

Applicant: JOHN F. FARMAN

FILE 213-75-R
APPENDIX B

Request: RM-900 to G

S.T.R.: W 23-20-6

2466

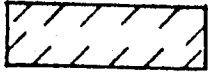
 Proposed
Reclassification



0' 200'

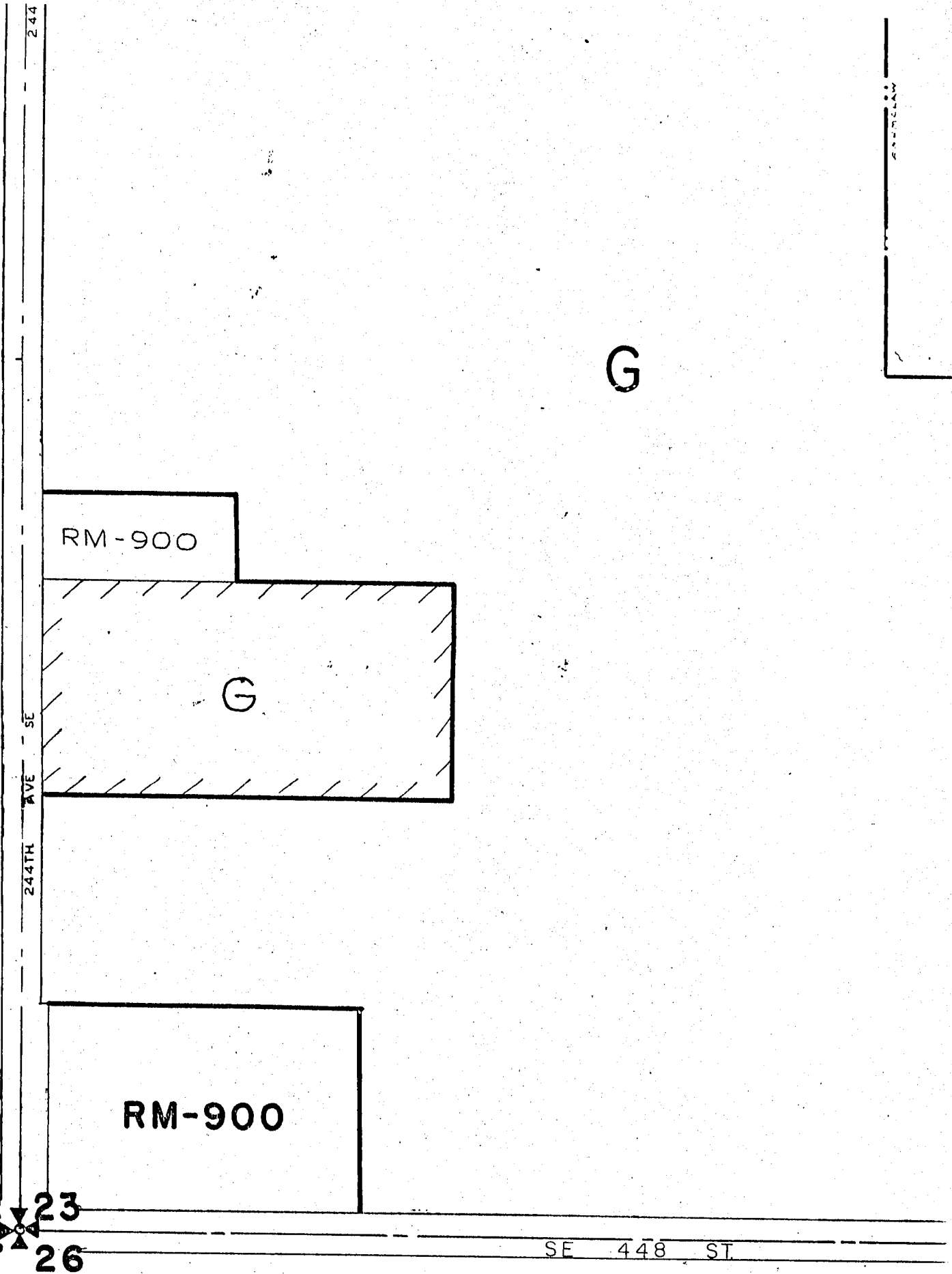

W 23-20-6

1 directs that Area Map W 23-20-6 be modified to so designate.

2 INTRODUCED AND READ for the first time this 3rd day

3 of March, 1975.

4 PASSED at a regular meeting of the King County Council

5 this 11th day of August, 1975.

6 KING COUNTY COUNCIL
7 KING COUNTY, WASHINGTON

8 Bill Reams

9 Chairman

10 ATTEST:

11 Janet M. Owens
12 Clerk of the Council

DEEMED ENACTED WITHOUT
COUNTY EXECUTIVE'S SIGNATURE. 5
13 DATED: August 21, 1975.

14 APPROVED this _____ day of

15 _____
16 KING COUNTY EXECUTIVE

17
18
19
20
21
22
23
24
25
26
27
28
29
30
31

FILE NO. 213-75-R
APPENDIX A

OVERALL LEGAL DESCRIPTION:

The south 1/2 of the northwest 1/4 of the southwest 1/4 of the southwest
1/4 of Section 23, Township 20 North, Range 6 E.W.M. less County Roads
all in King County Washington.

Applicant: JOHN F. FARMAN

FILE 213-75-R
APPENDIX B

Request: RM-900 to G

S.T.R.: W 23-20-6

2466

 Proposed
Reclassification



0' 200'

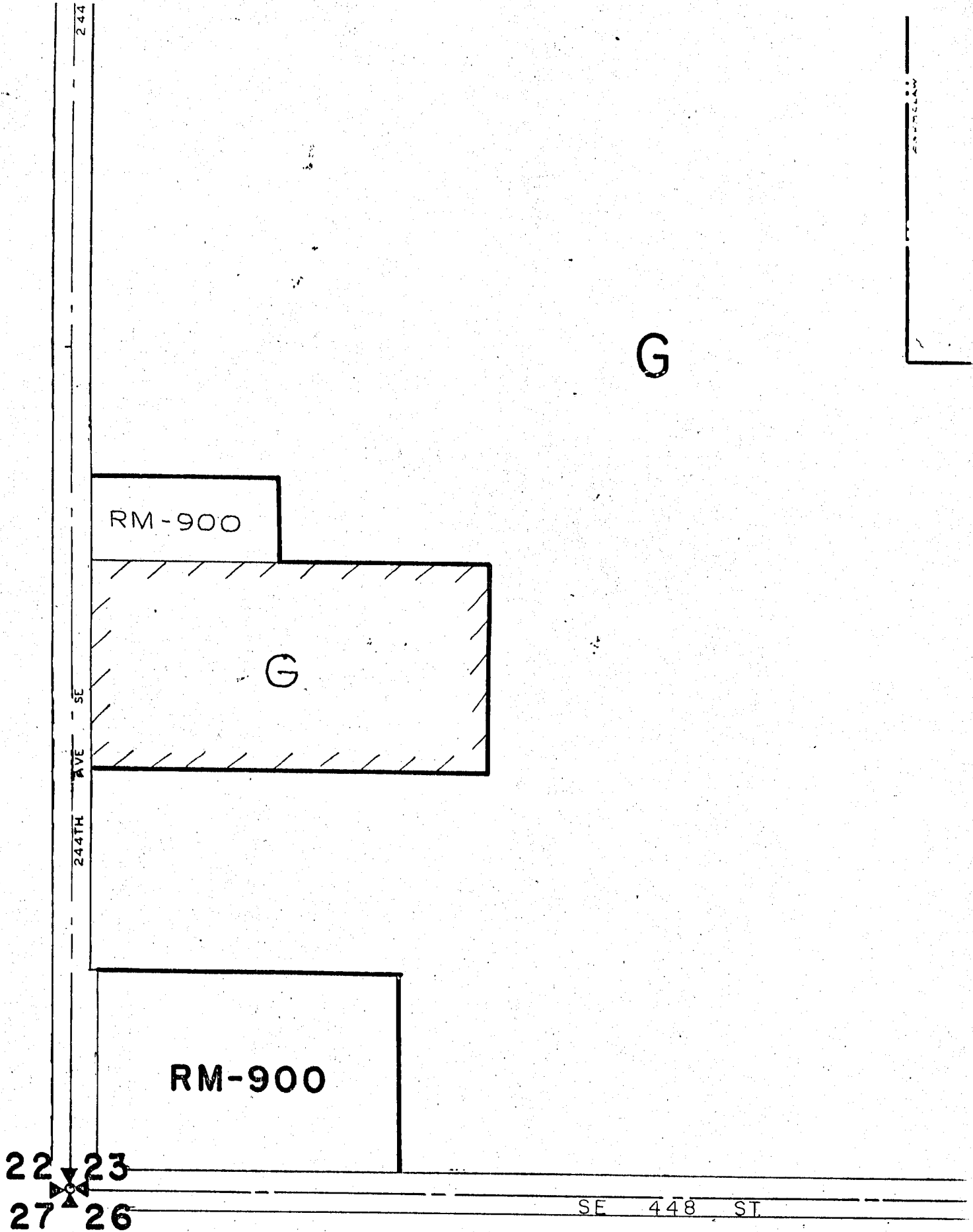

W 23-20-6